

Return
 Alan Richter
 % Wilsey + Ham
 1035 E. Hillside Blvd.
 San Mateo, Calif. 94404

8197
 OFFICIAL RECORDS
 PLACER COUNTY-CALIF.
 RECORD REQUESTED BY
 DEPT. PUBLIC WORKS
 APR 8 9 15 AM '74
 MAURINE I. DOBBAS
 COUNTY RECORDER
 8197 \$300

CERTIFICATION OF CORRECTION

NOTICE IS HEREBY GIVEN that that certain Subdivision Map entitled, "TRACT NO. 260, NORTHSTAR UNIT 4, A CONDOMINIUM DEVELOPMENT BEING A PORTION OF SECTION 32, T.17 E., R.17 E. & SEC. 5, T. 16 N., R. 17 E. M.D.M.", filed for record on February 15, 1974 in Book K of Maps, on Page 13, Placer County Records, is corrected as to the unit numbers of Building 13, as said building is shown on Page 7 of above Subdivision Map, as follows:

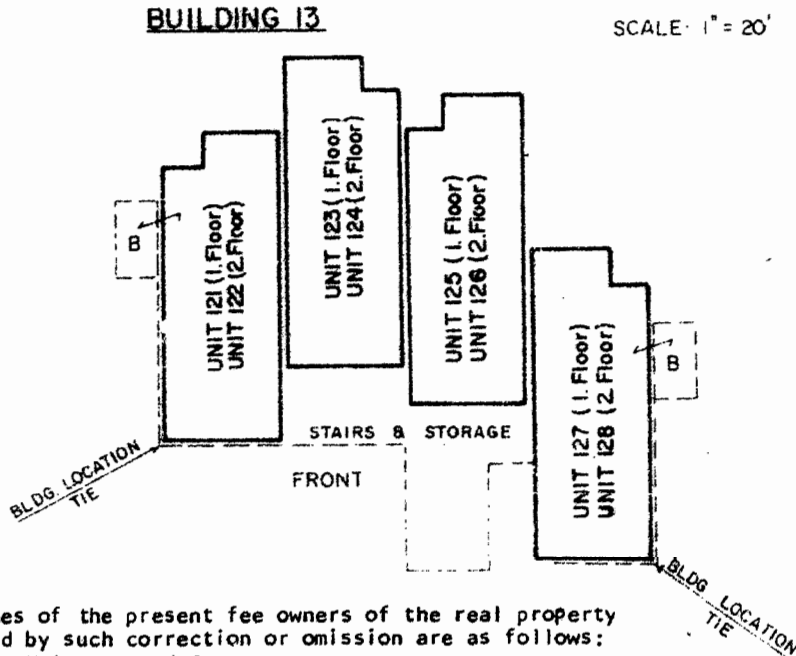

The names of the present fee owners of the real property affected by such correction or omission are as follows:

1. Trimont Land Company
2. Fibreboard Corporation, Holder of Title for Security purposes.

CERTIFICATE OF SURVEYOR

THIS IS TO CERTIFY that the above Certificate of Correction was prepared by or under the direction and control of the undersigned Licensed Land Surveyor.

Alan L. Richter, L.S. 3383

CERTIFICATE OF COUNTY SURVEYOR

THIS IS TO CERTIFY that the above Certificate of Correction has been examined this 5 day of April, 1974, for conformance with the requirements of Section 8770.5 of Land Surveyors Act and Section 11629 of the Subdivision Map Act.

John L. Shotwell
 Placer County Surveyor, R.C.E. 11171